

DAEWOO/CHEVROLET														
0,8 F 8 B	30 kW (41 PS)			01/86→	<b>S80940-00</b> <sup>12</sup> <sup>13</sup> <b>D80940-01</b> <sup>12</sup>	<b>H80940-00</b> 68,7 Ø 			<b>N93015-00</b>			<b>X82170-01</b> 	<b>X54890-01</b> 	<b>P77582-01</b> K ← 32x47x8 A SL RD NBR <b>P77503-01</b> K → 94 535 475 60x80x8 A SL LD MVQ <b>P77582-01</b> N 32x47x8 A SL RD NBR
0,8 F 8 C F 8 CV	35-38 kW (48-52 PS)	MATIZ MATIZ LPG SPARK TICO		02/95→	<b>S38539-00</b> <sup>12</sup> <sup>13</sup> 93 740 053 +94 535 484 (6x) <b>D53538-00</b> <sup>12</sup>	<b>H40038-00</b> 94 580 082 69,5 Ø 	<b>T40038-00</b> 94 580 081 (8x) 	<b>X83283-01</b> 94 580 083 	<b>N90112-01</b> 94 535 484 (6x)	<b>X89727-01</b> 96 352 281 Mot.→685255  <b>X59709-01</b> 96 569 406 Mot.685256→  <b>X59710-01</b> 96 569 405 Mot.685256→ 		<b>X59699-01</b> 96 569 653 	<b>70-31414-10</b> 	<b>P77581-01</b> K ← 94 535 472 32x47x6 A SL RD MVQ <b>P77503-01</b> K → 94 535 475 60x80x8 A SL LD MVQ <b>P77581-01</b> N 94 535 472 32x47x6 A SL RD MVQ
1,0 B 10 D1	50 kW (68 PS)	SPARK SPARK LPG		03/10→	<b>D38552-00</b> <sup>12</sup> <b>B38553-00</b> <sup>13</sup>	<b>H40644-00</b> 25 184 663 70,8 Ø 	<b>T40644-00</b> 96 416 362 (10x) 	<b>X59662-01</b> 96 416 270 ACM 	<b>N93180-00</b> 96 440 882 (16x) <b>P93180-00</b> 96 440 882	<b>X59661-01</b> 96 416 314 16x 		<b>X59701-01</b> 96 416 309 	<b>70-31414-10</b> 	<b>P76953-01</b> K ← 96 416 399 36x50x6 A SL RD FPM <b>P76954-01</b> K → 96 416 398 60x80x8 AB SL LD FPM
1,0 B 10 S B 10 S1 G 10 CV LA2	44-49 kW (60-67 PS)	MATIZ MATIZ LPG SPARK		11/02→	<b>S59674-00</b> <sup>12</sup> <sup>13</sup> 93 740 055 +94 535 484 (8x)	<b>H59674-00</b> 96 963 220 70 Ø 	<b>T40038-01</b> 94 580 081 (10x) 	<b>X59665-00</b> 96 325 175 ACM 	<b>N93182-00</b> 94 535 484 (8x) <b>P76947-00</b> 94 535 484	<b>X59655-01</b> 96 571 108 8x 		<b>X59673-01</b> 96 325 689 	<b>70-31414-10</b> 	<b>P77581-01</b> K ← 94 535 472 32x47x6 A SL RD MVQ <b>P77503-01</b> K → 94 535 475 60x80x8 A SL LD MVQ <b>P77581-01</b> N 94 535 472 32x47x6 A SL RD MVQ
1,2 A 12 XEL A 12 XER LDC LWD	51-63 kW (69-86 PS)	AVEO AVEO LPG SPIN		03/11→	<del><b>S38313-01</b> <sup>12</sup> <sup>13</sup></del> <del><b>D38314-01</b> <sup>12</sup></del>	<b>H40593-00</b> 55 562 233 74 Ø MLS 	<b>T59487-00</b> 55 566 811 (12x) 	<b>X59502-01</b> 55 561 429 ACM  <b>X59815-01</b> 55 573 747 ACM 	<b>N92115-00</b> 09 158 057 (16x) <b>P76707-00</b> 09 158 057	<b>X59513-01</b> 55 563 660 16x  <b>X59514-01</b> 55 563 650 	4x	<b>X81822-01</b> 55 566 925 	<b>70-31414-10</b> 	<b>P77155-01</b> K ← 42x55x7 A SL RD FPM <b>P76341-01</b> K → 96 376 569 80x98x10 A SL LD FPM

DAEWOO/CHEVROLET													
Ltr.													
1,2 B 12 D1 LMU	55-62 kW (75-84 PS) AVEO AVEO LPG SPARK SPARK LPG	01/08→		D38552-00 <sup>12</sup> B38553-00 <sup>13</sup>	H40644-00 25 184 663 70,8 Ø 	T40644-00 96 416 362 (10x) 	X59662-01 96 416 270 ACM 	N93180-00 96 440 882 (16x) P93180-00 96 440 882	X59661-01 96 416 314 16x 		X59701-01 96 416 309 	70-31414-10 	P76953-01 K ← 96 416 399 36x50x6 A SL RD FPM P76954-01 K → 96 416 398 60x80x8 AB SL LD FPM
1,2 B 12 S1 F 12 S3	53 kW (72 PS) AVEO KALOS	03/05→		S59674-00 <sup>12</sup> <sup>13</sup> 93 740 055 +94 535 484 (8x)	H59674-00 96 963 220 70 Ø 	T40038-01 94 580 081 (10x) 	X59665-00 96 325 175 ACM 	N93182-00 94 535 484 (8x) P76947-00 94 535 484	X59655-01 96 571 108 8x 		X59673-01 96 325 689 	70-31414-10 	P77581-01 K ← 94 535 472 32x47x6 A SL RD MVQ P77503-01 K → 94 535 475 60x80x8 A SL LD MVQ P77581-01 N 94 535 472 32x47x6 A SL RD MVQ
1,2 Z 12 XE	59-63 kW (80-86 PS)			D36802-00 <sup>12</sup> B32992-00 <sup>13</sup>	H40390-00 ✗ 79,5 Ø 0,57 mm MLS H80490-00 79,5 Ø 0,32 mm MLS 	T80083-00 	V36963-00 90 466 480 +90 411 826 X53917-01 NBR 	N92115-00 09 158 057 (16x) P76707-00 09 158 057	X88909-01 16x 		X52443-01 	X54489-01 ACM 	P77155-01 K ← 42x55x7 A SL RD FPM P76341-01 K → 96 376 569 80x98x10 A SL LD FPM
1,3 LDV LSF	55-70 kW (75-95 PS) AVEO D	07/11→		D38343-00 <sup>12</sup>  B38343-00 <sup>13</sup> 	H08120-00 55 209 070 70,5 Ø 0,72 mm MLS H18120-10 55 209 071 70,5 Ø 0,82 mm 1 MLS H28120-20 55 209 072 70,5 Ø 0,92 mm 2 MLS 	T08128-00 55 192 265 (10x)  RIBE	X83008-01 93 177 255 Metall 	N92990-00 12 855 396 (16x) P76662-00 12 855 396	X59540-01 12 855 498 16x 		X81490-01 12 855 456 	70-31414-10 	P77355-01 K ← 55 186 758 40x52x7 AB SL RD ACM FPM P77340-01 K → 55 180 937 78x100x9 A SL LD PTFE

DAEWOO/CHEVROLET												
Ltr.			<b>1</b>									
1,3 Z 13 DTJ	55 kW (75 PS)			<b>D36649-00</b> <sup>12</sup>  <b>B36649-00</b> <sup>13</sup> 	<b>H08120-00</b> 55 209 070 70,5 Ø 0,72 mm MLS <b>H18120-10</b> 55 209 071 70,5 Ø 0,82 mm 1 MLS <b>H28120-20</b> 55 209 072 70,5 Ø 0,92 mm 2 MLS 	<b>T08128-00</b> 55 192 265 (10x)  RIBE	<b>X83008-01</b> 93 177 255 Metall 	<b>N92990-00</b> 12 855 396 (16x) <b>P76662-00</b> 12 855 396 16x	<b>X87558-01</b> 	<b>X81490-01</b> 12 855 456 	<b>70-31414-10</b> 	<b>P77355-01 K</b> ← 55 186 758 40x52x7 AB SL RD ACM FPM <b>P77340-01 K</b> → 55 180 937 78x100x9 A SL LD PTFE
1,4 A 13 DM	55 kW (75 PS)		01/97→	<b>D31650-00</b> <sup>12</sup> 	<b>H50080-00</b> 79,5 Ø 1,95 mm 	<b>T06582-00</b> 	<b>X53158-01</b> 96 181 318 NBR 	<b>N92310-00</b> 96 229 145 (8x) <b>P76601-00</b> 96 229 145 8x	<b>X56030-01</b> 96 341 175 	<b>X04280-01</b> 96 341 176 	<b>P76095-01 N</b> 55 563 374 35x48x7 A SL RD MVQ	
1,4 A 14 NET B 14 NET	103 kW (140 PS)	CRUZE TRAX LPG	09/10→	<b>D38309-01</b> <sup>12</sup>  <b>B38315-00</b> <sup>13</sup> 	<b>H40593-00</b> 55 562 233 74 Ø MLS 	<b>T59487-00</b> 55 566 811 (12x) 	<b>X59502-01</b> 55 561 429 ACM   <b>X59815-01</b> 55 573 747 ACM 	<b>N92115-00</b> 09 158 057 (16x) <b>P76707-00</b> 09 158 057 16x	<b>X59511-01</b> 55 566 664 	<b>X82525-01</b> 	<b>70-31414-10</b> 	<b>P77155-01 K</b> ← 42x55x7 A SL RD FPM <b>P76341-01 K</b> → 96 376 569 80x98x10 A SL LD FPM
1,4 A 14 SMS A13DM	55 kW (75 PS)	LANOS	05/97→	<b>D31650-00</b> <sup>12</sup> 	<b>H50080-00</b> 79,5 Ø 1,95 mm 	<b>T06582-00</b> 	<b>X53158-01</b> 96 181 318 NBR 	<b>N92310-00</b> 96 229 145 (8x) <b>P76601-00</b> 96 229 145 8x	<b>X56030-01</b> 96 341 175 	<b>X04280-01</b> 96 341 176 	<b>P76095-01 N</b> 55 563 374 35x48x7 A SL RD MVQ	
1,4 A 14 XER LDD	74 kW (100-101 PS)	AVEO CRUZE	04/08→	<b>S38313-01</b> <sup>12</sup> <sup>13</sup>  <b>D38314-01</b> <sup>12</sup> 	<b>H40593-00</b> 55 562 233 74 Ø MLS 	<b>T59487-00</b> 55 566 811 (12x) 	<b>X59502-01</b> 55 561 429 ACM 	<b>N92115-00</b> 09 158 057 (16x) <b>P76707-00</b> 09 158 057 16x	<b>X59513-01</b> 4x 55 563 660   <b>X59514-01</b> 55 563 650 	<b>X81822-01</b> 55 566 925 	<b>70-31414-10</b> 	<b>P77155-01 K</b> ← 42x55x7 A SL RD FPM <b>P76341-01 K</b> → 96 376 569 80x98x10 A SL LD FPM

DAEWOO/CHEVROLET													
Ltr.													
1,4 C 14 NZ	44 kW (60 PS)	CORSA	08/94-07/97	<b>D31226-00</b> <sup>(12)</sup> Mot.→19489817 <b>D31650-00</b> <sup>(12)</sup> Mot.19489818→ <b>B31226-00</b> <sup>(13)</sup> <b>B32228-00</b> <sup>(13) (27)</sup>	<b>H50080-00</b> 79,5 Ø 1,95 mm 	<b>T06582-00</b>  <b>T16582-00</b> 	<b>X53090-01</b> 9 mm Kork Mot.→19489817 <b>X53158-01</b> 96 181 318 NBR Mot.19489818→ 	<b>N92310-00</b> 96 229 145 (8x) <b>P76601-00</b> 96 229 145	<b>X56030-01</b> 96 341 175 8x 	<b>X04280-01</b> 96 341 176 <b>X06583-01</b> <sup>(A)</sup> 	<b>X04285-01</b> 2x  <b>X54385-01</b> NBR 	<b>P76040-01</b> K ← 26x42x8 AB SL RD FPM <b>P76341-01</b> K → 96 376 569 80x98x10 A SL LD FPM <b>P76095-01</b> N 55 563 374 35x48x7 A SL RD MVQ	
1,4 F 14 D3 L14 L95	69-70 kW (93-95 PS)	AVEO CRUZE	01/06→	<b>S54115-01</b> <sup>(12) (13)</sup> 93 742 687 <b>D38525-00</b> <sup>(12)</sup>	<b>H59675-00</b> 96 963 220 80 Ø 	<b>T40052-00</b> 94 501 031 (10x) 	<b>X59460-01</b> 96 353 002 	<b>N93036-00</b> 96 840 122 (16x) <b>P76950-00</b> 96 480 122	<b>X59656-01</b> 4x 96 461 130 	<b>X59696-01</b> 96 378 805 	<b>70-31414-10</b> 	<b>P77598-01</b> K ← 96 350 161 30x42x8 SL RD MVQ <b>P76341-01</b> K → 96 376 569 80x98x10 A SL LD FPM <b>P76144-01</b> N 2x 42x56x7 A SL RD MVQ	
1,4 F 14 D3	69-70 kW (94-95 PS)	GENTRA KALOS LACETTI NUBIRA	04/03→	<b>S54110-00</b> <sup>(12) (13)</sup> 93 740 513 →12/05 <b>S54115-01</b> <sup>(12) (13)</sup> 93 742 687 01/06→ <b>D38517-00</b> <sup>(12)</sup> →12/05 <b>D38525-00</b> <sup>(12)</sup> 01/06→	<b>H40653-00</b> 96 378 802 80 Ø →12/05  <b>H59675-00</b> 96 963 220 80 Ø 01/06→ 	<b>T40052-00</b> 94 501 031 (10x) 	<b>X59460-01</b> 96 353 002 	<b>N93036-00</b> 96 840 122 (16x) <b>P76950-00</b> 96 480 122	<b>X59656-01</b> 4x 96 461 130 	<b>X59696-01</b> 96 378 805 	<b>70-31414-10</b> 	<b>P77598-01</b> K ← 96 350 161 30x42x8 SL RD MVQ <b>P76341-01</b> K → 96 376 569 80x98x10 A SL LD FPM <b>P76144-01</b> N 2x 42x56x7 A SL RD MVQ	
1,4 F 14 D4	74 kW (101 PS)	AVEO	04/08→	<b>D37088-00</b> <sup>(12)</sup> <b>B37087-00</b> <sup>(13)</sup> 	<b>H80748-00</b> 55 355 578 82 Ø 0,65 mm MLS 	<b>T50479-00</b> 90 412 701 (10x) 	<b>X83138-01</b> 55 354 237 NBR 	<b>N92005-00</b> 24 405 819 (16x) <b>P76800-00</b> 24 405 819	<b>X89310-01</b> 16x 55 564 974 	<b>X81995-01</b> 12 992 396 	<b>70-31414-10</b> 	<b>P77409-01</b> K ← 24 447 223 31,5x42x7 AB SL RD FPM <b>P77463-01</b> K → 55 555 805 80x98x14,7 A SL LD FPM <b>P76095-01</b> N 2x 55 563 374 35x48x7 A SL RD MVQ	
1,4 F 14 S3	61 kW (83 PS)	KALOS	03/05→	<b>S27270-00</b> <sup>(12) (13)</sup> 93 740 205 +96 229 145 (8x) <b>D31652-00</b> <sup>(12)</sup>	<b>H06582-00</b> 96 391 434 80,5 Ø 1,3 mm 	<b>T38510-00</b> 94 501 001 (10x) 	<b>X53158-01</b> 96 181 318 NBR 	<b>N92310-00</b> 96 229 145 (8x) <b>P76601-00</b> 96 229 145	<b>X56030-01</b> 8x 96 341 175 	<b>X04280-01</b> 96 341 176 	<b>70-31414-10</b> 	<b>P77598-01</b> K ← 96 350 161 30x42x8 SL RD MVQ <b>P76341-01</b> K → 96 376 569 80x98x10 A SL LD FPM <b>P76095-01</b> N 55 563 374 35x48x7 A SL RD MVQ	

DAEWOO/CHEVROLET													
1,4 LUJ	103 kW (140 PS)	AVEO CRUZE ORLANDO TRAX	09/10→	D38309-01 <sup>12</sup>  B38315-00 <sup>13</sup>	H40593-00 55 562 233 74 Ø MLS 	T59487-00 55 566 811 (12x) 	X59815-01 55 573 747 ACM 	N92115-00 09 158 057 (16x) P76707-00 09 158 057	X59511-01 55 566 664 16x 	X82525-01 	70-31414-10 	P77155-01 K ← 42x55x7 A SL RD FPM P76341-01 K → 96 376 569 80x98x10 A SL LD FPM	
1,4 LUU	111 kW (151 PS)	VOLT	11/11→		H40593-00 55 562 233 74 Ø MLS 	T59487-00 55 566 811 (12x) 	X59815-01 55 573 747 ACM 	N92115-00 09 158 057 (16x) P76707-00 09 158 057	X59833-01 55 573 211 16x 	X81822-01 55 566 925 	70-31414-10 	P77155-01 K ← 42x55x7 A SL RD FPM P76341-01 K → 96 376 569 80x98x10 A SL LD FPM	
1,4 X 14 XE	68 kW (92 PS)			D32228-00 <sup>12</sup> B31226-00 <sup>13</sup> B32228-00 <sup>13</sup> <sup>27</sup>	H50479-00 79,5 Ø 	T50479-00 90 412 701 (10x) 	V36958-00 	N92990-00 12 855 396 (16x) P76662-00 12 855 396	X56925-01 16x X57656-01 <sup>10</sup> <sup>0</sup> 	X51343-01 	X04285-01  X54385-01 <sup>27</sup> NBR 	P76040-01 K ← 26x42x8 AB SL RD FPM P76341-01 K → 96 376 569 80x98x10 A SL LD FPM P76095-01 N 55 563 374 35x48x7 A SL RD MVQ	
1,4 Z 14 XE	66 kW (90 PS)			D36405-00 <sup>12</sup> B36960-00 <sup>13</sup> 	H80330-00 80,5 Ø MLS 	T50479-00 90 412 701 (10x) 	X53916-01 NBR 	N92990-00 12 855 396 (16x) P76662-00 12 855 396	X86615-01 16x X86614-01 <sup>10</sup> 	X52984-01 	70-31414-10 	P76040-01 K ← 26x42x8 AB SL RD FPM P76341-01 K → 96 376 569 80x98x10 A SL LD FPM P76095-01 N 55 563 374 35x48x7 A SL RD MVQ	
1,5 A 15 DMS A 15 SMS	63-81 kW (86-110 PS)	LACETTI LANOS NUBIRA	04/97→	D31650-00 <sup>12</sup>	H50080-00 79,5 Ø 1,95 mm 	T06582-00 	X53158-01 96 181 318 NBR 	N92310-00 96 229 145 (8x) P76601-00 96 229 145	X56030-01 96 341 175 8x 	X04280-01 96 341 176 		P76095-01 N 55 563 374 35x48x7 A SL RD MVQ	
1,5 A 15 MF	65-66 kW (88-90 PS)	ESPERO NEXIA	10/93-06/99	S40051-00 <sup>12</sup> <sup>13</sup> D40051-00 <sup>12</sup>	H40051-00 96 391 433 78 Ø 		V37983-00 	N93036-00 96 840 122 (16x)	X89742-01 96 352 947 	X82265-01 		P77598-01 K ← 96 350 161 30x42x8 SL RD MVQ P77526-01 K → 80x98x10 A SL LD NBR P77614-01 N 42x56x7 SL RD MVQ	

DAEWOO/CHEVROLET													
Ltr.													
1,5 F 15 S3 LX6	62 kW (84 PS) AVEO	05/05→		<b>S40051-02</b> <sup>12</sup> <sup>13</sup> 93 740 204 +96 229 145 (8x)	<b>H40051-00</b> 96 391 433 78 Ø 	<b>T38510-00</b> 94 501 001 (10x) 	<b>X53158-01</b> 96 181 318 NBR 	<b>N92310-00</b> 96 229 145 (8x) <b>P76601-00</b> 96 229 145	<b>X56030-01</b> 96 341 175 8x 		<b>X04280-01</b> 96 341 176 	<b>70-31414-10</b> 	<b>P77598-01 K</b> ← 96 350 161 30x42x8 SL RD MVQ <b>P76341-01 K</b> → 96 376 569 80x98x10 A SL LD FPM <b>P76095-01 N</b> 55 563 374 35x48x7 A SL RD MVQ
1,5 G 15 MF 16SV	44-55 kW (60-75 PS) NEXIA	02/95-08/97		<b>D31186-00</b> <sup>12</sup> <b>B31186-00</b> <sup>13</sup>	<b>H06582-00</b> 96 391 434 80,5 Ø 1,3 mm 	<b>T06582-00</b> 	<b>X53090-01</b> 9 mm Kork 	<b>N92310-00</b> 96 229 145 (8x) <b>P76601-00</b> 96 229 145	<b>X87475-01</b> 8x 		<b>X04280-01</b> 96 341 176  <b>X08209-01</b> <sup>13</sup> 	<b>X04285-01</b> 	<b>P76040-01 K</b> ← 26x42x8 AB SL RD FPM <b>P76341-01 K</b> → 96 376 569 80x98x10 A SL LD FPM <b>P76095-01 N</b> 55 563 374 35x48x7 A SL RD MVQ
1,6 A 16 DMS	76-78 kW (103-106 PS) LANOS NUBIRA	05/97→		<b>S38562-00</b> <sup>12</sup> <sup>13</sup> <sup>34</sup> 93 740 209 <b>S40052-00</b> <sup>12</sup> <sup>13</sup> <sup>32</sup> <b>D38563-00</b> <sup>12</sup> <sup>34</sup> <b>D40052-00</b> <sup>12</sup> <sup>32</sup>	<b>H40052-00</b> 96 391 436 80,5 Ø 1,6 mm 	<b>T40052-00</b> 94 501 031 (10x) 	<b>V37988-00</b> <sup>32</sup> 96 351 213 +96 144 621 (2x)  <b>X59460-01</b> <sup>34</sup> 96 353 002 	<b>N93036-00</b> 96 840 122 (16x) <b>P76950-00</b> 96 480 122	<b>X89742-01</b> 96 352 947 16x 		<b>X59696-01</b> 96 378 805 	<b>70-31414-10</b> 	<b>P77598-01 K</b> ← 96 350 161 30x42x8 SL RD MVQ <b>P76341-01 K</b> → 96 376 569 80x98x10 A SL LD FPM <b>P76144-01 N</b> 2x 42x56x7 A SL RD MVQ
1,6 A 16 DMS	77-78 kW (105-106 PS) VIVANT	08/01→		<b>S38562-00</b> <sup>12</sup> <sup>13</sup> 93 740 209 <b>D38563-00</b> <sup>12</sup>	<b>H40052-00</b> 96 391 436 80,5 Ø 1,6 mm 	<b>T40052-00</b> 94 501 031 (10x) 	<b>X59460-01</b> 96 353 002 	<b>N93036-00</b> 96 840 122 (16x) <b>P76950-00</b> 96 480 122	<b>X59832-01</b> 4x 96 376 372 16x 		<b>X59696-01</b> 96 378 805 	<b>70-31414-10</b> 	<b>P77598-01 K</b> ← 96 350 161 30x42x8 SL RD MVQ <b>P76341-01 K</b> → 96 376 569 80x98x10 A SL LD FPM <b>P76144-01 N</b> 2x 42x56x7 A SL RD MVQ
1,6 C 16 SE	74 kW (100 PS)			<b>D31652-00</b> <sup>12</sup> <b>B31226-00</b> <sup>13</sup>	<b>H06582-00</b> 96 391 434 80,5 Ø 1,3 mm 	<b>T06582-00</b>  <b>T16582-00</b> 	<b>X53158-01</b> 96 181 318 NBR 	<b>N92310-00</b> 96 229 145 (8x) <b>P76523-00</b> <b>P76601-00</b> 96 229 145	<b>X56030-01</b> 96 341 175 8x 8x 		<b>X04280-01</b> 96 341 176 	<b>X04285-01</b> 2x 	<b>P76040-01 K</b> ← 26x42x8 AB SL RD FPM <b>P76341-01 K</b> → 96 376 569 80x98x10 A SL LD FPM <b>P76095-01 N</b> 55 563 374 35x48x7 A SL RD MVQ

DAEWOO/CHEVROLET													
Ltr.			<b>1</b>										
1,6 C 16 XE	80 kW (109 PS)			<b>D31651-00</b> <sup>12</sup> <b>B32228-00</b> <sup>13</sup> <sup>27</sup>	<b>H50218-00</b> 80,5 Ø 	<b>T50479-00</b> 90 412 701 (10x) 	<b>X53148-01 ES</b> NBR  <b>X53149-01 AS</b> NBR 	<b>N92990-00</b> 12 855 396 (16x) <b>P76662-00</b> 12 855 396	16x <b>X56925-01</b> 		<b>X51343-01</b> 	<b>X54385-01</b> NBR 	<b>P76040-01 K</b> ← 26x42x8 AB SL RD FPM <b>P76341-01 K</b> → 96 376 569 80x98x10 A SL LD FPM <b>P76095-01 N</b> 2x 55 563 374 35x48x7 A SL RD MVQ
1,6 F 16 D3	76-80 kW (103-109 PS)	AVEO GENTRA LACETTI NUBIRA OPTRA	07/03→	<b>S54110-00</b> <sup>12</sup> <sup>13</sup> 93 740 513 →12/05 <b>S54115-01</b> <sup>12</sup> <sup>13</sup> 93 742 687 01/06→ <b>D38517-00</b> <sup>12</sup> →12/05 <b>D38525-00</b> <sup>12</sup> 01/06→	<b>H40653-00</b> 96 378 802 80 Ø →12/05  <b>H59675-00</b> 96 963 220 80 Ø →01/06 	<b>T40052-00</b> 94 501 031 (10x) 	<b>X59460-01</b> 96 353 002 	<b>N93036-00</b> 96 840 122 (16x) <b>P76950-00</b> 96 480 122	16x <b>X59656-01</b> 96 461 130 	4x 	<b>X59696-01</b> 96 378 805 	<b>70-31414-10</b> 	<b>P77598-01 K</b> ← 96 350 161 30x42x8 SL RD MVQ <b>P76341-01 K</b> → 96 376 569 80x98x10 A SL LD FPM <b>P76144-01 N</b> 2x 42x56x7 A SL RD MVQ
1,6 F 16 D3 LXT	78-80 kW (106-109 PS)	CRUZE NEXIA OPTRA	08/03→	<b>S54115-01</b> <sup>12</sup> <sup>13</sup> 93 742 687 <b>D38525-00</b> <sup>12</sup>	<b>H59675-00</b> 96 963 220 80 Ø 	<b>T40052-00</b> 94 501 031 (10x) 	<b>X59460-01</b> 96 353 002 	<b>N93036-00</b> 96 840 122 (16x) <b>P76950-00</b> 96 480 122	16x <b>X59656-01</b> 96 461 130 	4x 	<b>X59696-01</b> 96 378 805 	<b>70-31414-10</b> 	<b>P77598-01 K</b> ← 96 350 161 30x42x8 SL RD MVQ <b>P76341-01 K</b> → 96 376 569 80x98x10 A SL LD FPM <b>P76144-01 N</b> 2x 42x56x7 A SL RD MVQ
1,6 F 16 D4 LDE <b>[NEW]</b>	83-91 kW (113-124 PS)	AVEO CRUZE TRAX	05/09→	<b>D37088-00</b> <sup>12</sup> <b>B37087-00</b> <sup>13</sup> 	<b>H80748-00</b> 55 355 578 82 Ø 0,65 mm MLS 	<b>T50479-00</b> 90 412 701 (10x) 	<b>X83138-01</b> 55 354 237 NBR 	<b>N92005-00</b> 24 405 819 (16x) <b>P76800-00</b> 24 405 819	16x <b>X59913-01</b> 55 568 787 		<b>X81995-01</b> 12 992 396 	<b>70-31414-10</b> 	<b>P77409-01 K</b> ← 24 447 223 31,5x42x7 AB SL RD FPM <b>P77463-01 K</b> → 55 555 805 80x98x14,7 A SL LD FPM <b>P76095-01 N</b> 2x 55 563 374 35x48x7 A SL RD MVQ
1,6 LXV	76-80 kW (103-109 PS)	AVEO CRUZE	09/03→	<b>D37088-00</b> <sup>12</sup> <b>B37087-00</b> <sup>13</sup> 	<b>H80748-00</b> 55 355 578 82 Ø 0,65 mm MLS 	<b>T50479-00</b> 90 412 701 (10x) 	<b>X83138-01</b> 55 354 237 NBR 	<b>N92005-00</b> 24 405 819 (16x) <b>P76800-00</b> 24 405 819	16x <b>X89310-01</b> 55 564 974 		<b>X81995-01</b> 12 992 396 	<b>70-31414-10</b> 	<b>P77409-01 K</b> ← 24 447 223 31,5x42x7 AB SL RD FPM <b>P77463-01 K</b> → 55 555 805 80x98x14,7 A SL LD FPM <b>P76095-01 N</b> 2x 55 563 374 35x48x7 A SL RD MVQ

DAEWOO/CHEVROLET												
1,6 X 16 XE 75 kW (102 PS) CORSA	08/97-07/02			S32283-00 ⑫ ⑬ D32283-00 ⑫ B32228-00 ⑬ ⑳	H50833-00 80,5 Ø 	T50479-00 90 412 701 (10x) 	X53148-01 ES NBR  X53149-01 AS NBR 	N92990-00 12 855 396 (16x) P76662-00 12 855 396	X56925-01 16x  X57656-01 ⑩ 	X51343-01 	X54385-01 NBR 	P76040-01 K ← 26x42x8 AB SL RD FPM P76341-01 K → 96 376 569 80x98x10 A SL LD FPM P76095-01 N 55 563 374 35x48x7 A SL RD MVQ
1,6 Z 16 SE 62 kW (84 PS) CORSA	08/01→			D36686-00 ⑫ B36960-00 ⑬ 	H80382-00 80 Ø MLS 	T06582-00  T16582-00 	X53158-01 96 181 318 NBR 	N92310-00 96 229 145 (8x) P76601-00 96 229 145	X88105-01 8x 	X81605-01 	70-31414-10 	P76040-01 K ← 26x42x8 AB SL RD FPM P76341-01 K → 96 376 569 80x98x10 A SL LD FPM P76095-01 N 55 563 374 35x48x7 A SL RD MVQ
1,6 16 LZ2 55 kW (75 PS)					H80575-00 82 Ø 1,3 mm 	T07921-00 	X53298-01 Kork 	N92310-00 96 229 145 (8x) P76523-00 P76601-00 96 229 145	X07922-01 8x 8x 	X08205-01 	X54120-01 	P76085-01 K ← 90 183 572 31x50x8 A SL RD FPM P76384-01 K → 90 354 378 90x104x9/11 AB SL LD FPM P76095-01 N 55 563 374 35x48x7 A SL RD MVQ
1,7 A 17 DTE LUD [NEW] 81-96 kW (110-131 PS) CRUZE D CRUZE TD TRAX TD	01/12→			D37121-00 ⑫  B37121-00 ⑬	H01903-00 1 □ MLS H11903-10 2 □ MLS H21903-20 3 □ MLS 	T01831-00 	X83146-01 	N92990-00 12 855 396 (16x) P76662-00 12 855 396	X59512-01 16x 	X82052-01 	2x 70-31414-10 	P77427-01 K ← 40x52x6 A SL RD FPM P76373-01 K → 87x100x8 A SL LD ACM P76130-01 N 38x50x8 A SL RD FPM
1,7 Y 17 DT 55 kW (75 PS) CORSA DTI	08/01→			S36515-00 ⑫ ⑬  D36515-01 ⑫ 	H08698-00 1,45 mm 1 □ MLS H18698-10 1,5 mm 2 □ MLS H28698-20 80 Ø 1,55 mm 3 □ MLS 	T07916-00 	X53952-01 NBR 	N92990-00 12 855 396 (16x) P76662-00 12 855 396	X86878-01 16x  X86877-01 ⑩ 	X81065-01 	70-31414-10 	P77427-01 K ← 40x52x6 A SL RD FPM P76373-01 K → 87x100x8 A SL LD ACM P76130-01 N 38x50x8 A SL RD FPM



DAEWOO/CHEVROLET														
1,7 Y 17 DTL	44 kW (60 PS)	COMBO D CORSA D	08/00→	<p><b>S36515-00</b> <sup>12</sup> <sup>13</sup></p> <p><b>D36515-01</b> <sup>12</sup></p>	<p><b>H08698-00</b> 1,45 mm 1 </p> <p>MLS</p> <p><b>H18698-10</b> 1,5 mm 2 </p> <p>MLS</p> <p><b>H28698-20</b> 80 Ø 1,55 mm 3 </p> <p>MLS</p>	<b>T07916-00</b> 	<b>X53952-01</b> NBR 	<p><b>N92990-00</b> 12 855 396 (16x)</p> <p><b>P76662-00</b> 12 855 396</p> <p>16x</p>	<b>X86878-01</b> 		<b>X81065-01</b> 	<b>70-31414-10</b> 	<p><b>P77427-01</b> K ← 40x52x6 A SL RD FPM</p> <p><b>P76373-01</b> K → 87x100x8 A SL LD ACM</p> <p><b>P76130-01</b> N 38x50x8 A SL RD FPM</p>	
1,8 C 18 LE	66-70 kW (90-95 PS)	ESPERO LACETTI LEGANZA NUBIRA	02/95→	<p><b>D31180-00</b> <sup>12</sup></p> <p><b>B31180-00</b> <sup>13</sup></p>	<p><b>H07921-00</b> 86,3 Ø 1,3 mm</p>	<b>T07921-00</b> 	<b>X53091-01</b> Kork 	<p><b>N92310-00</b> 96 229 145 (8x)</p> <p><b>P76601-00</b> 96 229 145</p> <p>8x</p>	<b>X07922-01</b> 		<b>X08205-01</b> 	<b>X08209-01</b>	<b>X54121-01</b> NBR 	<p><b>P76085-01</b> K ← 90 183 572 31x50x8 A SL RD FPM</p> <p><b>P76384-01</b> K → 90 354 378 90x104x9/11 AB SL LD FPM</p> <p><b>P76095-01</b> N 55 563 374 35x48x7 A SL RD MVQ</p>
1,8 C 18 NE	81 kW (110 PS)	ASTRA	09/98→	<p><b>D31181-00</b> <sup>12</sup></p> <p><b>B31180-00</b> <sup>13</sup></p>	<p><b>H07921-00</b> 86,3 Ø 1,3 mm</p>	<b>T07921-00</b> 	<b>X53091-01</b> Kork 	<p><b>N92310-00</b> 96 229 145 (8x)</p> <p><b>P76523-00</b> <b>P76601-00</b> 96 229 145</p> <p>8x 8x</p>	<b>X07923-01</b> 		<b>X08205-01</b> 	<b>X06583-01</b>	<b>X54121-01</b> NBR 	<p><b>P76085-01</b> K ← 90 183 572 31x50x8 A SL RD FPM</p> <p><b>P76384-01</b> K → 90 354 378 90x104x9/11 AB SL LD FPM</p> <p><b>P76095-01</b> N 55 563 374 35x48x7 A SL RD MVQ</p>
1,8 F 18 D3	89 kW (121 PS)	LACETTI NUBIRA	08/05→	<p><b>D33000-03</b> <sup>12</sup> 92 066 550 +90 411 937</p> <p><b>B32999-00</b> <sup>13</sup> 92 061 971</p>	<p><b>H50466-00</b> 90 411 937 83 Ø 1,3 mm</p>	<b>T50466-00</b> 90 466 480 (10x) 	<p><b>V36963-00</b> 90 466 480 +90 411 826</p> <p><b>X53503-01</b> 90 501 944 NBR</p>	<p><b>N92990-00</b> 12 855 396 (16x)</p> <p><b>P76662-00</b> 12 855 396</p> <p>16x</p>	<b>X57657-01</b> 90 412 459 		<b>X51630-02</b> 92 063 157 	<b>70-31414-10</b> 	<p><b>P76085-01</b> K ← 90 183 572 31x50x8 A SL RD FPM</p> <p><b>P76384-01</b> K → 90 354 378 90x104x9/11 AB SL LD FPM</p> <p><b>P76095-01</b> N 55 563 374 35x48x7 A SL RD MVQ</p> <p>2x</p>	
1,8 F 18 D4 Z 18 XER 2H0	103-104 kW (140-141 PS)	AVEO LPG CRUZE CRUZE LPG ORLANDO ORLANDO LPG	05/09→	<p><b>D37089-00</b> <sup>12</sup></p> <p><b>B37087-00</b> <sup>13</sup></p>	<p><b>H80748-00</b> 55 355 578 82 Ø 0,65 mm MLS</p>	<b>T50479-00</b> 90 412 701 (10x) 	<b>X83138-01</b> 55 354 237 NBR 	<p><b>N92005-00</b> 24 405 819 (16x)</p> <p><b>P76800-00</b> 24 405 819</p> <p>16x</p>	<b>M37089-00</b> 93 185 729 		<b>X81995-01</b> 12 992 396 	<b>70-31414-10</b> 	<p><b>P77409-01</b> K ← 24 447 223 31,5x42x7 AB SL RD FPM</p> <p><b>P77463-01</b> K → 55 555 805 80x98x14,7 A SL LD FPM</p> <p><b>P76095-01</b> N 55 563 374 35x48x7 A SL RD MVQ</p> <p>2x</p>	

DAEWOO/CHEVROLET												
1,8 S 18 NV	74 kW (101 PS)	SUPER SALOON	08/92-08/95	D31180-00 <sup>12</sup> B31180-00 <sup>13</sup>	H07921-00 86,3 Ø 1,3 mm 	T07921-00 	X53091-01 Kork 	N92310-00 96 229 145 (8x) P76601-00 96 229 145	X07922-01 8x 	X08205-01 X08209-01 <sup>A</sup> 	X54121-01 NBR 	P76085-01 K ← 90 183 572 31x50x8 A SL RD FPM P76384-01 K → 90 354 378 90x104x9/11 AB SL LD FPM P76095-01 N ← 55 563 374 35x48x7 A SL RD MVQ P76222-01 N → 55x70,1x5/8 A SL LD FPM
1,8 T 18 SED	89-90 kW (121-122 PS)	LACETTI NUBIRA OPTRA	08/03→	S38578-00 <sup>12</sup> <sup>13</sup> 93 742 703	H40685-00 96 414 576 83 Ø MLS 		X59816-01 96 414 596 ACM 	N92990-00 12 855 396 (16x) P76662-00 12 855 396	X59837-01 96 414 577 16x 	X59838-01 96 414 578 	70-31414-10 	P77598-01 K ← 96 350 161 30x42x8 SL RD MVQ P76341-01 K → 96 376 569 80x98x10 A SL LD FPM P76095-01 N 55 563 374 35x48x7 A SL RD MVQ
1,8 Z 18 XE	90-92 kW (122-125 PS)	NIVA VIVA ZAFIRA	07/00-12/09	D36514-00 <sup>12</sup>	H80360-00 81,5 Ø MLS 	T50479-00 90 412 701 (10x) 	X53950-01 NBR 	N92115-00 09 158 057 (16x) P76707-00 09 158 057	X86876-01 16x 	X81064-01 	70-31414-10 	P77409-01 K ← 24 447 223 31,5x42x7 AB SL RD FPM P76341-01 K → 96 376 569 80x98x10 A SL LD FPM P76095-01 N 55 563 374 35x48x7 A SL RD MVQ
2,0 C 20 LE	72-85 kW (98-116 PS)	ESPERO LEMANS PRINCE	09/90-06/99	D31170-00 <sup>12</sup> B31180-00 <sup>13</sup>	H08276-00 87,5 Ø 1,3 mm 	T07921-00 	X53091-01 Kork 	N92310-00 96 229 145 (8x) P76601-00 96 229 145	X07923-01 8x 	X08205-01 X08209-01 <sup>A</sup> 	X54121-01 NBR 	P76085-01 K ← 90 183 572 31x50x8 A SL RD FPM P76384-01 K → 90 354 378 90x104x9/11 AB SL LD FPM P76095-01 N ← 55 563 374 35x48x7 A SL RD MVQ P76222-01 N → 55x70,1x5/8 A SL LD FPM
2,0 C 20 NE	81 kW (110 PS)	VECTRA	03/96-12/05	D31170-00 <sup>12</sup> B31180-00 <sup>13</sup>	H08276-00 87,5 Ø 1,3 mm 	T07921-00 	X53091-01 Kork 	N92310-00 96 229 145 (8x) P76523-00 P76601-00 96 229 145	X07923-01 8x 8x 	X08205-01 X06583-01 <sup>A</sup> X08209-01 <sup>A</sup> 	X54121-01 NBR 	P76085-01 K ← 90 183 572 31x50x8 A SL RD FPM P76384-01 K → 90 354 378 90x104x9/11 AB SL LD FPM P76095-01 N ← 55 563 374 35x48x7 A SL RD MVQ P76222-01 N → 55x70,1x5/8 A SL LD FPM

DAEWOO/CHEVROLET													
Ltr.													
2,0 C 20 NE	85 kW (116 PS)	ASTRA ZAFIRA	04/01→	D31170-00 <sup>12</sup> B31180-00 <sup>13</sup>	H08276-00 87,5 Ø 1,3 mm 	T07921-00 	X53091-01 Kork 	N92310-00 96 229 145 (8x) P76523-00 P76601-00 96 229 145	X07923-01 8x 8x 	X08205-01 X06583-01	X54121-01 NBR 	P76085-01 K ← 90 183 572 31x50x8 A SL RD FPM P76384-01 K → 90 354 378 90x104x9/11 AB SL LD FPM P76095-01 N ← 55 563 374 35x48x7 A SL RD MVQ P76222-01 N → 55x70,1x5/8 A SL LD FPM	
2,0 C 20 SED	94 kW (128 PS)	EPICA	01/05-12/06	D33005-09 <sup>12</sup> 93 742 408 +92 067 765 B32999-00 <sup>13</sup> 92 061 971 	H50467-00 92 067 765 87 Ø 1,3 mm 	T50466-00 90 466 480 (10x) 	V36963-00 90 466 480 +90 411 826  X53503-01 90 501 944 NBR 	N92990-00 12 855 396 (16x) P76662-00 12 855 396	X57657-01 90 412 459 16x 	X51630-02 92 063 157 	70-31414-10 	P76085-01 K ← 90 183 572 31x50x8 A SL RD FPM P76384-01 K → 90 354 378 90x104x9/11 AB SL LD FPM P76095-01 N 2x 55 563 374 35x48x7 A SL RD MVQ	
2,0 C 20 SEL	100 kW (136 PS)	ASTRA VECTRA ZAFIRA	03/96→	S32230-00 <sup>12</sup> <sup>13</sup> D32230-00 <sup>12</sup> B32230-00 <sup>13</sup>	H50467-00 92 067 765 87 Ø 1,3 mm 	T50466-00 90 466 480 (10x) 	X53503-01 90 501 944 NBR 	N92990-00 12 855 396 (16x) P76662-00 12 855 396	X57657-01 90 412 459 16x 	X51630-01 X08209-01	X54360-01 	P76085-01 K ← 90 183 572 31x50x8 A SL RD FPM P76384-01 K → 90 354 378 90x104x9/11 AB SL LD FPM P76095-01 N 2x 55 563 374 35x48x7 A SL RD MVQ	
2,0 LBS <b>[NEW]</b>	118 kW (160 PS)	MALIBU D	04/12→	D38297-00 <sup>12</sup>  B38134-00 <sup>13</sup>	H01460-00 0,95 mm MLS H11460-10 1,05 mm 1 MLS H21460-20 1,15 mm 2 MLS	T80476-00 90 537 691 (10x) 	X59714-01 	N93126-00 55 183 812 (16x) P76812-00 55 183 812	M59515-00 16x 	X82356-01 	70-31414-10 	P76444-01 K ← 31x41x7 AB SL RD FPM P77403-01 K → PTFE P77833-01 N 30x50x7 AW SL RD FPM	
2,0 LMN	89 kW (121 PS)				H01904-00 96 440 163 1,1 mm 1 MLS H11904-10 96 440 164 1,2 mm 2 MLS H21904-20 96 440 165 1,3 mm 3 MLS	T01830-00 94 501 932 (10x) 	X83353-01 96 440 309 	N93129-00 96 440 146 (16x)	X89875-01 96 440 379 	X82347-01 96 440 364 	70-31414-10 	P77331-01 K ← 96 440 222 32x45x6 A SL RD ACM P77692-01 K → 25 183 982 98x114x8 A SL LD FPM P77608-01 N 36x50x8 A SL LD NBR	

DAEWOO/CHEVROLET													
Ltr.			<b>1</b>										
2,0 LNF	186-194 kW (253-264 PS)				<b>H40467-00</b> 87 Ø 0,64 mm MLS 	<b>T80476-00</b> 90 537 691 (10x) 		<b>N92104-00</b> 90 537 241 (16x) <b>P76771-00</b> 90 537 241	<b>X89874-01</b> 16x 		<b>X82355-01</b> 12 622 668 	<b>70-31414-10</b> 	<b>P77343-01 K</b> → 90x104x11 A SL LD
2,0 LNP	120 kW (163 PS)	CRUZE	08/10→	<b>D38320-00</b> <sup>(12)</sup>  <b>B38319-00</b> <sup>(13)</sup>	<b>H40572-00</b> 25 190 137 87 Ø 1,05 mm 1 MLS <b>H40572-10</b> 25 190 138 87 Ø 1,15 mm 2 MLS <b>H40572-20</b> 25 190 139 87 Ø 1,25 mm 3 MLS 	<b>T38337-00</b> 94 502 227 (10x) 	<b>V59504-00</b> 25 186 594 	<b>N93126-00</b> 55 183 812 (16x) <b>P76812-00</b> 55 183 812	<b>X59708-01</b> 96 868 320 16x 		<b>X82524-01</b> 96 868 298 	<b>70-31414-10</b> 	<b>P77764-01 K</b> ← 96 868 128 50x65x8 A SL RD PTFE <b>P77763-01 K</b> → 96 868 243 98x114x8 A SL LD PTFE
2,0 LQ5	64-67 kW (87-91 PS)			<b>S59674-00</b> <sup>(12)</sup> <sup>(13)</sup> 93 740 055 +94 535 484 (8x)	<b>H59674-00</b> 96 963 220 70 Ø 	<b>T40038-01</b> 94 580 081 (10x) 	<b>X59665-00</b> 96 325 175 ACM 	<b>N93182-00</b> 94 535 484 (8x) <b>P76947-00</b> 94 535 484	<b>X59655-01</b> 96 571 108 8x 		<b>X59673-01</b> 96 325 689 	<b>70-31414-10</b> 	<b>P77581-01 K</b> ← 94 535 472 32x47x6 A SL RD MVQ <b>P77503-01 K</b> → 94 535 475 60x80x8 A SL LD MVQ <b>P77581-01 N</b> 94 535 472 32x47x6 A SL RD MVQ
2,0 LU2	147 kW (200 PS)			<b>D36769-00</b> <sup>(12)</sup> <b>B36769-00</b> <sup>(13)</sup>	<b>H80618-00</b> 87,5 Ø MLS 	<b>T50466-00</b> 90 466 480 (10x) 	<b>V36963-00</b> 90 466 480 +90 411 826  <b>X53503-01</b> 90 501 944 NBR 	<b>N92990-00</b> 12 855 396 (16x) <b>P76662-00</b> 12 855 396	<b>X57657-01</b> 90 412 459 16x 		<b>X81781-01</b> 	<b>X54360-01</b>  <b>X57747-01</b> <sup>(11)</sup> 	<b>P76085-01 K</b> ← 90 183 572 31x50x8 A SL RD FPM <b>P76384-01 K</b> → 90 354 378 90x104x9/11 AB SL LD FPM <b>P76095-01 N</b> 2x 55 563 374 35x48x7 A SL RD MVQ
2,0 X 20 D1	105 kW (144 PS)	EPICA	06/06→	<b>S40654-00</b> <sup>(12)</sup> <sup>(13)</sup> 93 740 211	<b>H40654-00</b> 96 370 861 76,2 Ø 	<b>T38511-00</b> 94 580 081 (14x) 	<b>X59660-01</b> 96 307 727 ACM 	<b>N93181-00</b> 96 307 714 (24x) <b>P93181-00</b> 96 307 714	<b>X59657-01</b> 96 307 801 6x 		<b>X59697-01</b> 96 493 411 Zyl. 4.5.6  <b>X59698-01</b> 96 493 410 Zyl. 1.2.3 	<b>70-31414-10</b> 	<b>P77424-01 K</b> ← 96 307 764 45x65x7 A SL RD FPM <b>P76353-01 K</b> → 96 521 516 85x105x8 A SL LD FPM

DAEWOO/CHEVROLET												
Ltr. 2,0 X 20 SED Z 20 L 89-98 kW (121-133 PS) LACETTI LEGANZA MAGNUS NUBIRA REZZO 04/97→	 <b>D32230-00</b> <sup>12</sup> <b>B32230-00</b> <sup>13</sup>	<b>H50467-00</b> 92 067 765 87 Ø 1,3 mm 	<b>T50466-00</b> 90 466 480 (10x) 	<b>V36963-00</b> 90 466 480 +90 411 826  <b>X53503-01</b> 90 501 944 NBR 	<b>N92990-00</b> 12 855 396 (16x) <b>P76662-00</b> 12 855 396 16x 	<b>X57657-01</b> 90 412 459 		<b>X51630-01</b> 	<b>X54360-01</b> <sup>23</sup>  <b>X57747-01</b> <sup>11</sup> <sup>23</sup> 	<b>P76085-01</b> K ← 90 183 572 31x50x8 A SL RD FPM <b>P76384-01</b> K → 90 354 378 90x104x9/11 AB SL LD FPM <b>P76095-01</b> N 55 563 374 35x48x7 A SL RD MVQ 2x		
2,0 X 20 XEV 94 kW (128 PS) ASTRA 03/99-07/02	<b>D32230-00</b> <sup>12</sup> <b>B32230-00</b> <sup>13</sup> <sup>23</sup>	<b>H50467-00</b> 92 067 765 87 Ø 1,3 mm 	<b>T50466-00</b> 90 466 480 (10x) 	<b>V36963-00</b> 90 466 480 +90 411 826  <b>X53503-01</b> 90 501 944 NBR 	<b>N92990-00</b> 12 855 396 (16x) <b>P76662-00</b> 12 855 396 16x 	<b>X57657-01</b> 90 412 459 		<b>X81608-01</b> <b>X06583-01</b> 	<b>X54360-01</b> <sup>23</sup> 	<b>P76085-01</b> K ← 90 183 572 31x50x8 A SL RD FPM <b>P76384-01</b> K → 90 354 378 90x104x9/11 AB SL LD FPM <b>P76095-01</b> N 55 563 374 35x48x7 A SL RD MVQ 2x		
2,0 Y 20 DTH 74 kW (101 PS) ASTRA DTI 08/02→	<b>D32751-00</b> <sup>12</sup>  <b>B32751-00</b> <sup>13</sup>	<b>H04274-00</b> 1,2 mm MLS <b>H14274-10</b> 1,3 mm 1 MLS <b>H24274-20</b> 85,5 Ø 1,4 mm 2 MLS 	<b>T04274-00</b> 	<b>X53516-01</b> ACM 	<b>N92990-00</b> 12 855 396 (16x) <b>P76662-00</b> 12 855 396 16x 	<b>X58518-01</b> 		<b>X52089-01</b> 	<b>X54631-01</b> Aluminium 	<b>P76163-01</b> K ← 45x60x8/9 A SL RD MVQ <b>P77157-01</b> K → 99x114x11 A SL LD FPM		
2,0 Z 20 DM 89 kW (121 PS) LACETTI D NUBIRA D 01/07→		<b>H01904-00</b> 96 440 163 1,1 mm 1 MLS <b>H11904-10</b> 96 440 164 1,2 mm 2 MLS <b>H21904-20</b> 96 440 165 1,3 mm 3 MLS 	<b>T01830-00</b> 94 501 932 (10x) 	<b>X83353-01</b> 96 440 309 	<b>N93129-00</b> 96 440 146 (16x) 	<b>X89875-01</b> 96 440 379 		<b>X82347-01</b> 96 440 364 	<b>70-31414-10</b> 	<b>P77331-01</b> K ← 96 440 222 32x45x6 A SL RD ACM <b>P77692-01</b> K → 25 183 982 98x114x8 A SL LD FPM <b>P77613-01</b> N 96 440 161 36x50x8 A SL RD NBR		

DAEWOO/CHEVROLET												
Ltr.												
2,0 Z 20 DMH Z 20 S	89-110 kW (121-150 PS) CAPTIVA D CRUZE CDI EPICA D NUBIRA D	01/05→		<b>H01904-00</b> 96 440 163 1,1 mm 1 MLS <b>H11904-10</b> 96 440 164 1,2 mm 2 MLS <b>H21904-20</b> 96 440 165 1,3 mm 3 MLS 	<b>T01830-00</b> 94 501 932 (10x) 	<b>X83353-01</b> 96 440 309 	<b>N93129-00</b> 96 440 146 (16x) 	<b>X89875-01</b> 96 440 379 	<b>X82347-01</b> 96 440 364 	<b>70-31414-10</b> 	<b>P77321-01 K</b> ← 70x112/167x20 PTFE <b>P77331-01 K</b> ← 96 440 222 32x45x6 A SL RD ACM <b>P77692-01 K</b> → 25 183 982 98x114x8 A SL LD FPM <b>P77613-01 N</b> 96 440 161 36x50x8 A SL RD NBR	
2,0 20 NEJ	81 kW (110 PS) VECTRA	03/96-12/05	<b>D36968-00</b> <sup>(12)</sup> <b>B32230-00</b> <sup>(13)</sup>	<b>H08276-00</b> 87,5 Ø 1,3 mm 	<b>T07921-00</b> 	<b>X53298-01</b> Kork 	<b>N92310-00</b> 96 229 145 (8x) <b>P76601-00</b> 96 229 145	<b>X07923-01</b> 8x 	<b>X08205-01</b> <b>X08209-01</b>	<b>X54360-01</b> <b>X57747-01</b> <sup>(11)</sup> 	<b>P76085-01 K</b> ← 90 183 572 31x50x8 A SL RD FPM <b>P76384-01 K</b> → 90 354 378 90x104x9/11 AB SL LD FPM <b>P76095-01 N</b> 55 563 374 35x48x7 A SL RD MVQ	
2,2 A 22 DMH Z 22 D1	120-135 kW (163-184 PS) CAPTIVA D	03/11→	<b>D38320-00</b> <sup>(12)</sup>  <b>B38319-00</b> <sup>(13)</sup>	<b>H40572-00</b> 25 190 137 87 Ø 1,05 mm 1 MLS <b>H40572-10</b> 25 190 138 87 Ø 1,15 mm 2 MLS <b>H40572-20</b> 25 190 139 87 Ø 1,25 mm 3 MLS 	<b>T38337-00</b> 94 502 227 (10x) 	<b>V59504-00</b> 25 186 594 	<b>N93126-00</b> 55 183 812 (16x) <b>P76812-00</b> 55 183 812	<b>X59708-01</b> 96 868 320 16x 	<b>X82524-01</b> 96 868 298 	<b>70-31414-10</b> 	<b>P77764-01 K</b> ← 96 868 128 50x65x8 A SL RD PTFE <b>P77763-01 K</b> → 96 868 243 98x114x8 A SL LD PTFE	
2,2 C 22 SEL	102 kW (139 PS) VECTRA	05/98-12/05	<b>D32230-00</b> <sup>(12)</sup> <b>B32999-00</b> <sup>(13)</sup> 92 061 971 	<b>H50467-00</b> 92 067 765 87 Ø 1,3 mm 	<b>T50466-00</b> 90 466 480 (10x) 	<b>V36963-00</b> 90 466 480 +90 411 826  <b>X53503-01</b> 90 501 944 NBR 	<b>N92990-00</b> 12 855 396 (16x) <b>P76662-00</b> 12 855 396	<b>X57657-01</b> 90 412 459 16x 	<b>X51630-01</b> <b>X06583-01</b>	<b>X54800-01</b> NBR  <b>X57747-01</b> <sup>(11)</sup> 	<b>P76085-01 K</b> ← 90 183 572 31x50x8 A SL RD FPM <b>P76384-01 K</b> → 90 354 378 90x104x9/11 AB SL LD FPM <b>P76095-01 N</b> 2x 55 563 374 35x48x7 A SL RD MVQ	

DAEWOO/CHEVROLET													
Ltr.													
2,2 MB OM 601 74 kW (101 PS)	MUSSO TD	09/99→	<b>D36484-00</b>  <b>B31389-00</b> <sup>13</sup>	<b>H50260-00</b> 90,5 Ø 1,8 mm <b>H50260-10</b> 90,5 Ø 2 mm 	<b>T50084-00</b> 	<b>X53076-01</b> NBR 	<b>N92880-00</b> <b>P76544-00</b> <b>P76602-00</b>	<b>X58678-01</b> 4x 4x 		<b>X51094-01</b> 	<b>X54083-01</b> 	<b>P76235-11</b> K ← 45x67x8 A SL RD FPM <b>P76377-01</b> K → 93x114x13 A SL LD FPM	
2,2 T 22 SED 100 kW (136 PS)	LEGANZA	04/99-12/02	<b>D33005-09</b> <sup>12</sup> 93 742 408 +92 067 765 <b>B32999-00</b> <sup>13</sup> 92 061 971 	<b>H50467-00</b> 92 067 765 87 Ø 1,3 mm 	<b>T50466-00</b> 90 466 480 (10x) 	<b>V36963-00</b> 90 466 480 +90 411 826  <b>X53503-01</b> 90 501 944 NBR 	<b>N92990-00</b> 12 855 396 (16x) <b>P76662-00</b> 12 855 396	<b>X57657-01</b> 90 412 459 16x 		<b>X51630-02</b> 92 063 157 	<b>X54360-01</b> 	<b>P76085-01</b> K ← 90 183 572 31x50x8 A SL RD FPM <b>P76384-01</b> K → 90 354 378 90x104x9/11 AB SL LD FPM <b>P76095-01</b> N 55 563 374 35x48x7 A SL RD MVQ	
2,2 Z 22 SE 108 kW (147 PS)	VECTRA	04/02-04/04	<b>D36665-00</b> <sup>12</sup> <sup>31</sup> <b>D37071-00</b> <sup>12</sup> <sup>34</sup> <b>B37071-00</b> <sup>13</sup> 	<b>H80476-00</b> 87 Ø MLS 	<b>T80476-00</b> 90 537 691 (10x) 	<b>V36665-00</b> <sup>31</sup>  <b>X83131-01</b> <sup>34</sup> 	<b>N92104-00</b> 90 537 241 (16x) <b>P76771-00</b> 90 537 241	<b>M36665-00</b> 16x 		<b>X81508-01</b> 	<b>70-31414-10</b> 	<b>P77155-01</b> K ← 42x55x7 A SL RD FPM <b>P76384-01</b> K → 90 354 378 90x104x9/11 AB SL LD FPM	
2,2 Z 22 YH 110-114 kW (150-155 PS)	VECTRA ZAFIRA	01/05→	<b>D37085-00</b> <sup>12</sup> <b>B37071-00</b> <sup>13</sup> 	<b>H80489-00</b> 87 Ø MLS 	<b>T80476-00</b> 90 537 691 (10x) 	<b>X83131-01</b> 	<b>N92104-00</b> 90 537 241 (16x) <b>P76771-00</b> 90 537 241	<b>M36665-00</b> 16x 		<b>X81508-01</b> 	<b>70-31414-10</b> 	<b>P77155-01</b> K ← 42x55x7 A SL RD FPM <b>P76384-01</b> K → 90 354 378 90x104x9/11 AB SL LD FPM	
2,3 M 111.970 103 kW (140 PS)	MUSSO	01/99→	<b>D36030-00</b> <sup>12</sup> <b>B31936-00</b> <sup>13</sup>	<b>H80500-00</b> 92 Ø 1,75 mm 	<b>T50309-00</b> 	<b>V31937-00</b> NBR 	<b>N92118-00</b> <b>P76792-00</b>	<b>X58981-01</b> 16x 2x 		<b>X51359-01</b> 	<b>X54089-01</b> 	<b>P76235-11</b> K ← 45x67x8 A SL RD FPM <b>P76377-01</b> K → 93x114x13 A SL LD FPM	
2,4 A 24 XE LE5 LE9	CAPTIVA HHR MALIBU	01/06→	<b>B38130-00</b> <sup>13</sup>	<b>H40578-00</b> 12 597 769 90 Ø MLS 	<b>T80476-00</b> 90 537 691 (10x) 	<b>V59499-00</b> 12 598 014 	<b>N92104-00</b> 90 537 241 (16x) <b>P76771-00</b> 90 537 241	<b>M59659-00</b> 24 455 112 (4x) <b>X59740-01</b> 96 307 801 4x 		<b>X82355-01</b> 12 622 668 	<b>70-31414-10</b> 	<b>P77155-01</b> K ← 42x55x7 A SL RD FPM <b>P77343-01</b> K → 90x104x11 A SL LD	

DAEWOO/CHEVROLET															
2,5 Ltr. LF4 X 25 D1	115 kW (156 PS)	EPICA	06/06→	<b>S38554-00</b> <sup>12</sup> <sup>13</sup> 93 740 212	<b>H40674-00</b> 96 451 758 78 Ø 	<b>T38511-00</b> 94 580 081 (14X) 	<b>X59660-01</b> 96 307 727 ACM 	<b>N93181-00</b> 96 307 714 (24X) <b>P93181-00</b> 96 307 714	<b>X59657-01</b> 96 307 801 6x 	<b>X59697-01</b> 96 493 411 Zyl. 4,5,6  <b>X59698-01</b> 96 493 410 Zyl. 1,2,3 	<b>70-31414-10</b> 	<b>P77424-01 K</b> ← 96 307 764 45x65x7 A SL RD FPM <b>P76353-01 K</b> → 96 521 516 85x105x8 A SL LD FPM			
2,8 Z 28 NET	184-188 kW (250-256 PS)	VECTRA	11/05→	<b>D38073-00</b> <sup>12</sup> R <b>D38074-00</b> <sup>12</sup> L	<b>H40465-00 R</b> MLS  <b>H40466-00 L</b> MLS 	<b>T80699-00</b> 2x 	<b>X83354-01 R</b>  <b>X83355-01 L</b> 	<b>N93128-00</b> 2x	<b>X89876-01 U</b> Mot.→61999999 <b>X89877-01 U</b> Mot.71000001→ <b>X89851-01</b> <sup>10</sup> 0 2x 	<b>X82350-01</b> 2x 		<b>P77666-01 K</b> ← 50x70x11 AB SL RD PTFE <b>P77819-01 K</b> → 173x228x11,6 A SL LD PTFE			
2,9 MB-OM 601 29TD	88 kW (120 PS)	KORANDO TD MUSSO TD	01/99→	<b>D31914-00</b> <sup>12</sup> <b>B36866-00</b> <sup>13</sup> <sup>35</sup>	<b>H50252-00</b> 90,5 Ø 1,7 mm <b>H50252-10</b> 90,5 Ø 2 mm 	<b>T50098-00</b> 	<b>X53079-01</b> NBR 	<b>N92600-00</b> <b>P76544-00</b> <b>P76602-00</b> 5x 5x	<b>X51108-01</b> 	<b>X51109-01</b> 	<b>X54086-01</b> 	<b>P76235-11 K</b> ← 45x67x8 A SL RD FPM <b>P77153-01 K</b> → PTFE			
2,9 MB-OM 662	72-73 kW (98-99 PS)	KORANDO D MUSSO D	01/99→	<b>D31914-00</b> <sup>12</sup> <b>B31490-00</b> <sup>13</sup>	<b>H50252-00</b> 90,5 Ø 1,7 mm <b>H50252-10</b> 90,5 Ø 2 mm 	<b>T50098-00</b> 	<b>X53079-01</b> NBR 	<b>N92600-00</b> <b>P76544-00</b> <b>P76602-00</b> 5x 5x	<b>X51108-01</b> 	<b>X51109-01</b> 	<b>X54764-01</b> 	<b>P76235-11 K</b> ← 45x67x8 A SL RD FPM <b>P76377-01 K</b> → 93x114x13 A SL LD FPM			
3,0 A 30 XH LF1 <b>[NEW]</b>	190 kW (258 PS)	CAPTIVA	01/10→		<b>H40465-00 R</b> MLS  <b>H40466-00 L</b> MLS 	<b>T80699-00</b> 2x 	<b>X59497-01 L</b>  <b>X59509-01 R</b> 	<b>N93128-00</b> 2x		<b>X82527-01</b> 2x 	<b>70-31414-10</b> 	<b>P77666-01 K</b> ← 50x70x11 AB SL RD PTFE			
3,0 C 30 NE	116-130 kW (158-177 PS)	PRINCE ROYALE SUPER SALOON	04/89-07/97	<b>S31653-00</b> <sup>12</sup> <sup>13</sup> <b>D31653-00</b> <sup>12</sup> <b>B30387-00</b> <sup>13</sup>	<b>H02313-00</b> 97,5 Ø 1,1 mm 	<b>T02313-00</b> 	<b>X07941-01</b> NBR 	<b>N92840-00</b> <b>P76635-00</b> 12x		<b>X51344-01</b> <sup>7</sup> 	<b>E30281-00</b> 	<b>P76163-01 K</b> ← 45x60x8/9 A SL RD MVQ <b>P76320-01 K</b> → 77x100,1x11,45 A SL LD FPM			
3,2 M 104.992 M 104.995	156-162 kW (212-220 PS)	KORANDO MUSSO	01/99→	<b>D36446-00</b>  <b>B31946-00</b> <sup>13</sup>	<b>H50249-00</b> 91 Ø 1,75 mm 	<b>T50254-00</b> 	<b>V31959-00</b> 	<b>N92118-00</b> <b>P76792-00</b> 24x	<b>X53113-01</b> 6x 	<b>X52438-01</b> 2x 	<b>X54081-01</b> 	<b>P76235-11 K</b> ← 45x67x8 A SL RD FPM <b>P76377-01 K</b> → 93x114x13 A SL LD FPM			



DAEWOO/CHEVROLET

Ltr. 



1

3,2 Z 32 SE 155 kW (211 PS)

D37086-00 <sup>12</sup>  
Mot.31000001→  
B36717-00



H80602-00 2x  
88,5 Ø  
MLS

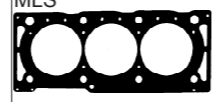

T50220-00



V31630-00 2x  
Mot.→21999999

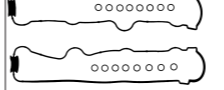

V37086-00 2x  
NBR  
Mot.31000001→

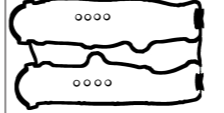

N92830-00  
P76662-00 24x  
12 855 396



X81691-01 2x

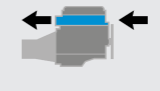

P76130-01 K ←  
38x50x8  
A SL RD FPM  
P76384-01 K →  
90 354 378  
90x104x9/11  
AB SL LD FPM  
P76095-01 N 4x  
55 563 374  
35x48x7  
A SL RD MVQ



3,2 Z 32 SEE 167 kW (227 PS)

WINSTORM

12/06→

H40465-00 R  
MLS



H40466-00 L  
MLS

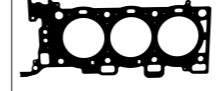

T80699-00 2x



X83354-01 R

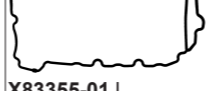

X83355-01 L



N93128-00 2x

X89876-01 U  
X89851-01 <sup>10</sup> 0 2x



P77666-01 K ←  
50x70x11  
AB SL RD PTFE